

Delta® HT-E-SEER-S

Project _____
Item _____
Quantity _____
CSI Section 11400 _____
Approval _____
Date _____

Delta® HT-E-SEER-S

Models

Delta HT-E-SEER-S

Short/Underbar Design



Standard Features

- Steam Elimination
- Energy Recovery System collects the hot water vapor inside the machine and uses it to preheat the incoming rinse water
- Operates on a single cold water connection
- Soft Start helps protect glassware from chipping and breaking
- 6" (153 mm) clearance facilitates cleaning beneath the machine
- Stainless steel rear dress panel
- Automatic fill
- Push button start
- Door interlock
- Pressure regulator
- Built-in booster heater with Sani-Sure™ final rinse system
- Automatic pumped drain for floor and wall drain installations
- Stainless steel wash pump
- Universal timer
- Digital LED control panel
- Delime cycle
- Simplified controls allow easy access for operation and service
- Built-in chemical pumps and priming switches

Mandatory Specs

Specify voltage _____

Options

- ☐ Water Hammer Arrestor
- ☐ Drain Water Tempering Kit
- ☐ Scale Prevention System (SPS)
- ☐ Replacement Cartridge for SPS

Accessories

- ☐ 36-Compartment Rack
 - ☐ 4-1/8" tall (105 mm)
 - ☐ 5-5/8" tall (143 mm)
 - ☐ 7" tall (178 mm)
- ☐ Combination Rack
- ☐ Peg Rack

NOTE: A vent hood is not recommended above the Jackson Delta HT-E-SEER as it does not produce excessive vapors. Always check with the local building code to know what type of ventilation is required for commercial dish machine or glasswasher installations in your area.

Specifications

High temperature undercounter dishwasher with steam elimination and energy recovery

Operates on a single cold water connection

Uses 0.65 gallons (2.47 liters) of water per rack

Uses 13.0 gallons (49.21 liters) of water per hour

Cleans 20 racks per hour

Cleans 720 glasses per hour

12" (305 mm) chamber clearance

Practical 21.88" (556 mm) loading height

Three selectable cycles:
Normal - 145 seconds
Heavy - 213 seconds
Extra-Heavy - 313 seconds

Powerful 1 hp wash pump motor

Air insulated between body and stainless steel housing

One (1) each peg and combination rack included

Durable stainless steel construction



Intertek



Intertek



Delta® HT-E-SEER-S

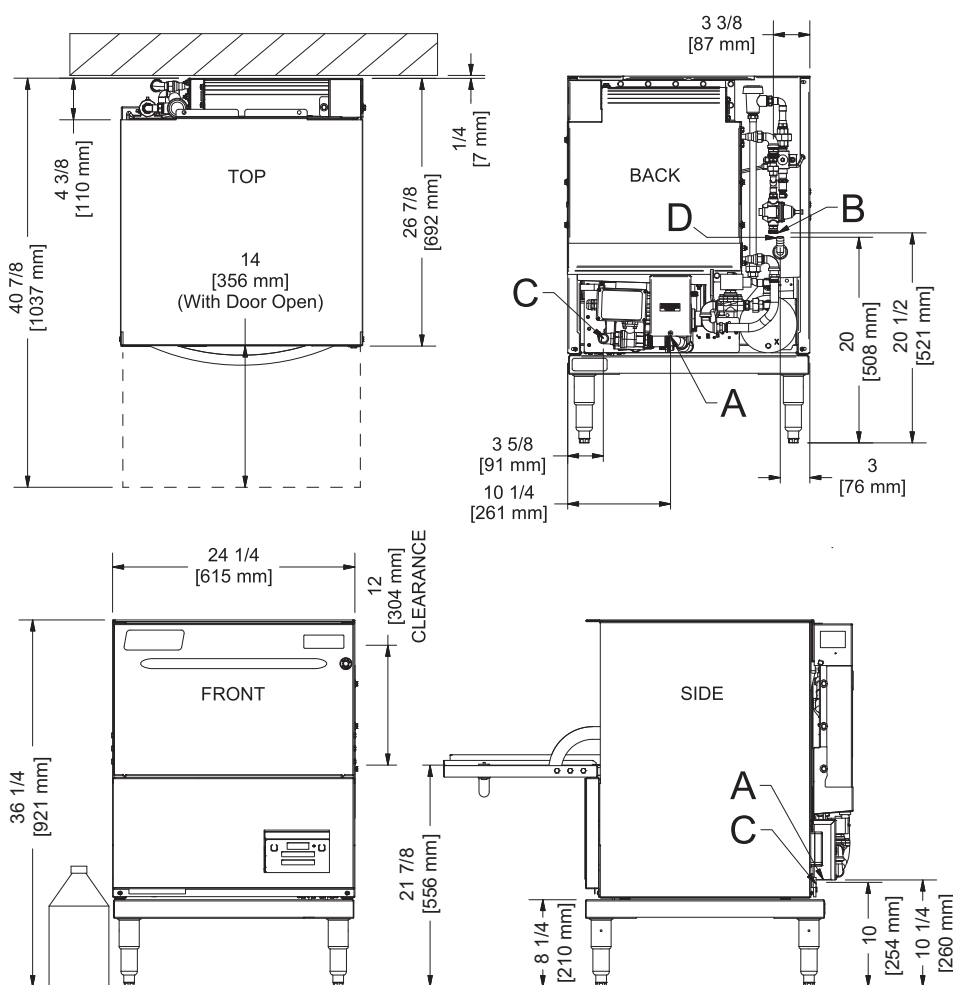

LEGEND:

- A - Electrical Connection
- B - Water Inlet (with 6' Hose)
(3/4" Male GHT, connect to true 1/2" ID line, 40-90 °F)
- C - Drain Connection
(1" ID, 1 3/8" OD)
- D - Chemical Port

All dimensions from the floor can be increased 1" using the machine's adjustable feet.

All views shown without rear dress panel.

MODEL NO.	MACHINE DIMENSIONS				WALL CLEARANCE	SHIPPING INFORMATION					
	INSIDE CLEARANCE HEIGHT	INSIDE CLEARANCE WIDTH	INSIDE CLEARANCE DEPTH	DOOR OPEN DEPTH		WEIGHT	CLASS	CUBE	HEIGHT	WIDTH	DEPTH
Delta HT-E-SEER-S	12" (305 mm)	20" (508 mm)	20" (508 mm)	40.83" (1037 mm)	1/4" (6 mm)	296 lbs (135 kg)	85	23.58 cu. ft.	48.25" (1226 mm)	28" (712 mm)	28.5" (724 mm)

APPROXIMATE TOTAL AMP LOADS

208/60/1	24.7
230/60/1	26.7

WASH PUMP MOTOR

Wash Pump	1 hp (208/230v)/ 3/4 hp (460v)
-----------	--------------------------------

WATER REQUIREMENTS

Incoming Water Temperature	40-90° F (4.4-32.2° C)
Gallons per Rack	0.65 gal (2.47 L)
Gallons per Hour	13 gal (49.21 L)
Flow Pressure (PSI)	10
Waterline Size (NPT)	3/4" Male GHT (connect to true 1/2" ID Line)
Drainline Size (OD)	1-3/8"

OPERATING CAPACITY

Racks per Hour	20
Dishes per Hour	500
Glasses per Hour	720

OPERATING CYCLE (seconds)	Wash	Rinse	Dwell	Vent	Total Cycle
Cycle I (Normal)	80	09	11	45	145
Cycle II (Heavy)	148	09	11	45	213
Cycle III (Extra Heavy)	248	09	11	45	313

OPERATING TEMPERATURES

Wash	155° F (68.3° C)
Rinse	180° F (82.2° C)

HOW TO SPECIFY: Delta HT-E-SEER-S

Jackson WWS, Inc.

Shipping Address: 6209 North U.S. Highway 25E, Gray, KY 40734

Mailing Address: P.O. Box 1060, Barbourville, KY 40906

Telephone: 888-800-5672 • Fax: 606-523-1799

Email: info@jacksonwws.com

07610-004-57-18 [05/01/18]

www.jacksonwws.com

We reserve the right to change specifications in this bulletin without incurring any obligation for equipment previously or subsequently sold.