



**Toll Free Number:** 1 (800) 931-8628



**Email:** Info@dukersusa.com



**Website:** www.dukersusa.com

## MODEL: DSP29-8-S1

### Features and Benefits

- \* High Resistance to Dust, high quality condenser
- \* R290 Natural Refrigerant, promotes faster cool down and efficient energy consumption
- \* 3-year parts and labor, 5-year compressor warranty
- \* Stainless steel inside and outside, sealed interior floors and round cabinet corners for easy cleaning
- \* Self-closing doors with stay open feature.
- \* Adjustable, heavy duty shelves
- \* Insulated canopy safely maintains a steady temperature range from 33-41 degrees.
- \* 4-inch polycarbonate 1/6 pans with durable clear food pan cover.



### Technical Specifications

Voltage/Frequency 115V 60Hz

Refrigerant R290

Type of Defrost Automatic

Exterior Finish Stainless steel

Interior Finish Stainless steel

Net Weight 202 bs

Total Capacity 6.56 cu ft

Total Current 2.0A

Climatic Category 4/5

Nema Config. 5-15P

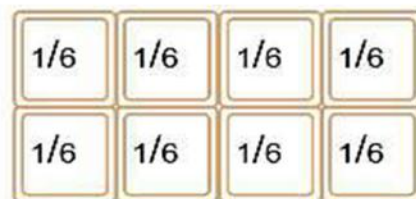

| MODEL NO   | TEMPERATURE RANGE ( °F ) | EXTERNAL DIMENSION WXDHX(INCHES) | PACKING,CARTON WXDHX(INCHES) | DOOR | 40GP CONTAINER CERTIFICATION |
|------------|--------------------------|----------------------------------|------------------------------|------|------------------------------|
| DSP29-8-S1 | 33°- 41° F               | 29" X 31 1/2" X 45 5/8"          | 30 1/2" X 33 1/8" X 50 3/4"  | 1    | 84                           |

# FOOD PREP TABLE REFRIGERATOR - REGULAR

## MODEL: DSP29-8-S1

|                        |  |
|------------------------|--|
| Model:                 | DSP29-8-S1                             |
| Rated Voltage:         | 115V AC                                |
| Rated Frequency:       | 60Hz                                   |
| Total Input Power:     | 225W                                   |
| Total Current:         | 2.0A                                   |
| Total Capacity:        | 6.56 cu ft                             |
| Refrigerant:           | R290/2.82 oz                           |
| Climatic Category:     | 4/5                                    |
| Protection Type        | I                                      |
| Design pressure        | High Side :300PSIG<br>Low Side:150PSIG |
| Insulation Blowing Gas | C-pentane                              |
| Net Weight:            | 202 lbs                                |
| NEMA Cofig.            | 5-15P                                  |
| 1/6 Pan Count          | 8                                      |

## STANDARD FEATURES

### BACK MOUNT COMPRESSOR

The back mount compressor structure is placed in the coolest possible area, provides quick and easy service

### HIGH QUALITY STEEL

Interior and exterior uses high-quality steel to minimizes dents, scratches and rust

### HIGH DENSITY POLYURETHANE INSULATION CFC

free and high density cell foam is Eco-friendly and more energy efficient

### STURDY, CLEAN STAINLESS SHELVING

high quality coated stainless shelves prevent peel and rust.

### SELF-CLOSING DOOR SYSTEM

door Automatically closes at 60°

### REFRIGERATORS OPERATE AT

33°- 41° F



## PLAN VIEW

FRONT VIEW

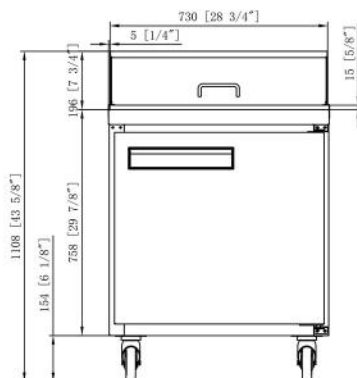

SIDE VIEW

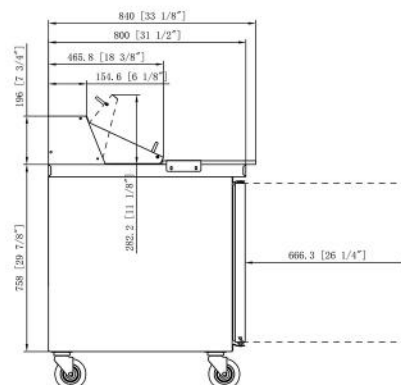

**California Office**  
2488 Peck Road,  
City of Industry, CA 90601  
(562) 568-4060  
www.dukersusa.com

**New Jersey Office**  
475 S Clinton Ave  
South Plainfield, NJ 07080  
(800) 608-9289  
Info@dukersusa.com

**Georgia Office**  
6513 Warren Dr  
NW Norcross, GA 30093  
(678) 580-3960  
service@dukersusa.com

**Texas Office**  
1444 N Cockrell Hill Rd  
#104 Dallas, TX 75211  
(469) 421-1040  
Warrenrty@dukersusa.com